

# DRIP EDGE FASCIA

TPO / PVC VERSION WITH FACTORY APPLIED TPO OR PVC FLASHING WITHOUT CONTINUOUS CLEAT

NOTE: INSTALL MITERS FIRST

INSTALLATION INSTRUCTIONS

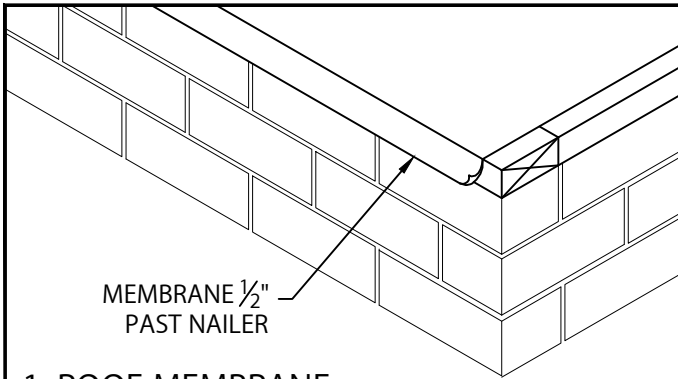

## 1. ROOF MEMBRANE

POSITION MEMBRANE OVER THE ROOF EDGE AND DOWN OUTSIDE FACE OF WALL, COVERING WOOD NAILER(S) COMPLETELY. ALLOW  $\frac{1}{2}$ " EXCESS MEMBRANE.

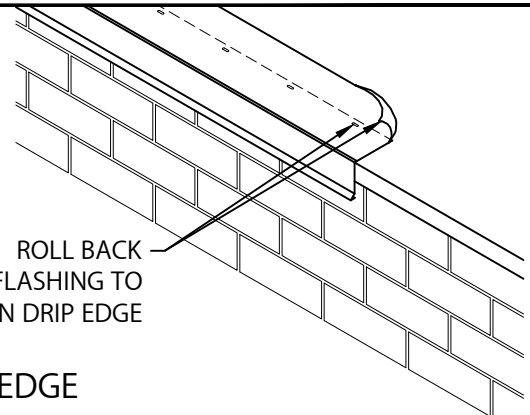

## 2. DRIP EDGE

PLACE DRIP EDGE ON WALL. ROLL BACK FLASHING TO EXPOSE FASTENING SLOTS AND FASTEN THRU PRE-SLOTTED HOLES 6" WITH PROVIDED FASTENERS.

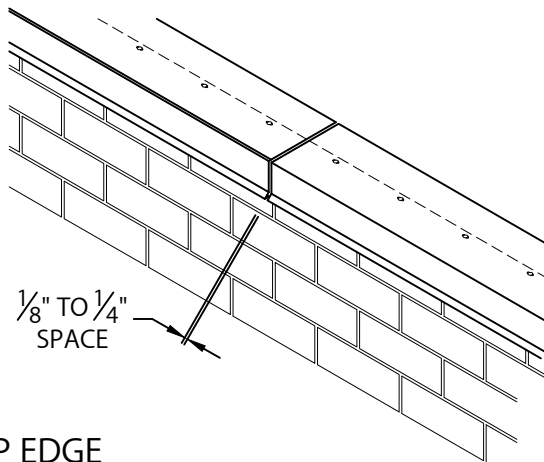

## 3. DRIP EDGE

CONTINUE INSTALLING LENGTHS OF DRIP EDGE. LEAVE A  $\frac{1}{8}$ " TO  $\frac{1}{4}$ " SPACE BETWEEN PIECES.

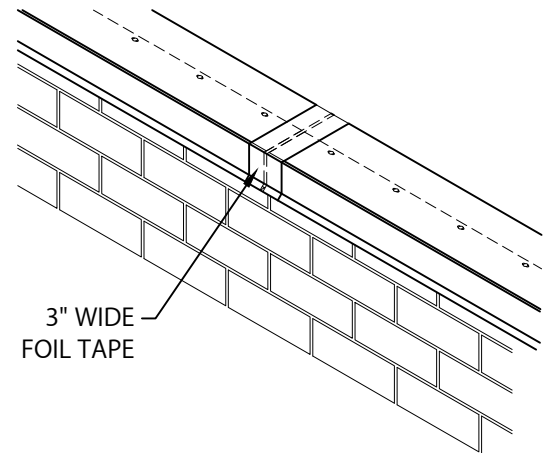

## 4. FOIL TAPE AT JOINT

PLACE A 3" WIDE PIECE OF FOIL TAPE OVER JOINT.

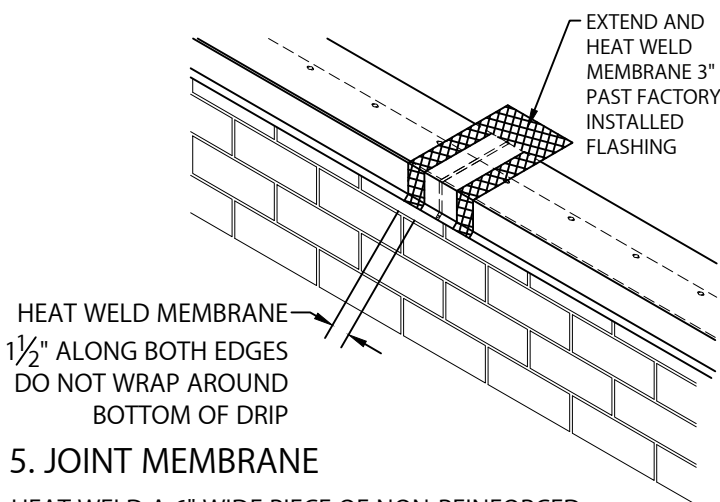

## 5. JOINT MEMBRANE

HEAT WELD A 6" WIDE PIECE OF NON-REINFORCED MEMBRANE OVER JOINT AS SHOWN ABOVE.

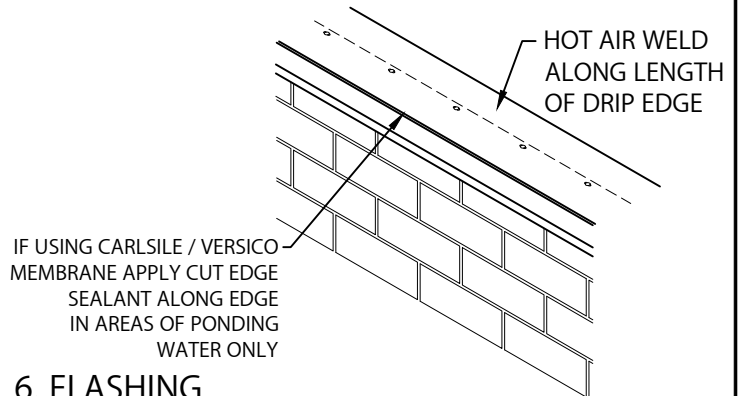

## 6. FLASHING

HOT AIR WELD ALONG ENTIRE LENGTH OF DRIP EDGE PER MANUFACTURERS INSTRUCTIONS. IF USING CARLSILE / VERSICO MEMBRANE, APPLY CUT EDGE SEALANT ONLY TO EDGES WHERE PONDING OCCURS.

**HICKMAN**  
EDGE SYSTEMS

Phone: 828-676-1700

[www.hickmanedgesystems.com](http://www.hickmanedgesystems.com)

DATE: 02/09/22

DRN BY: ZS

CKD BY: MM

SHT.# 1 OF 2

DWG# 64110-37732

**B**

# DRIP EDGE FASCIA

TPO / PVC VERSION WITH FACTORY APPLIED TPO OR PVC FLASHING WITHOUT CONTINUOUS CLEAT

NOTE: INSTALL MITERS FIRST

INSTALLATION INSTRUCTIONS

## TYPICAL INSTALLATION

