

PermaSpan Expansion Joints

PermaSpan Expansion Joints complement your building's natural aesthetics, with no exposed fasteners or unsightly cover plates to detract from the look. PermaSpan Expansion Joints are ideal for allowing thermal movement and condensation control between two roof systems or roof and terminating wall. The expansion joint prevents condensation by insulating against internal building temperatures.

The continuous cleat protects the PermaSpan Expansion Joints from wind-driven rain. Hickman also offers expansion joints with the 3-axis movement that allows for vertical motion for live loads with no loss of thermal or seismic motion. This carefully engineered product ensures long-lasting quality and high performance.

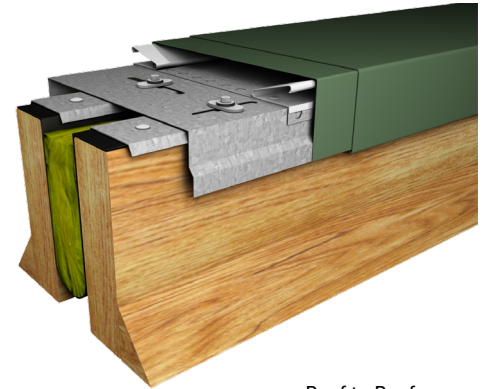

Roof to Roof
Version

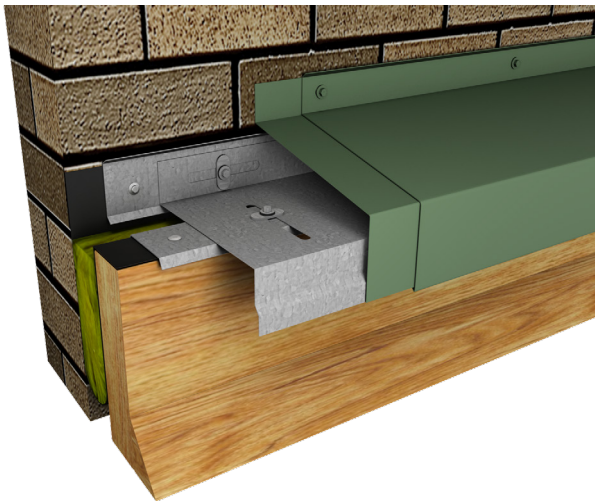

Roof to Wall
Version

PermaSpan Expansion Joints At-A-Glance

- » 20 Year, 120 MPH Wind Warranty
- » Variety of Colors, Sizes & Materials
- » No Exposed Fasteners or Unsightly Cover Plates
- » Continuous Cleat Protects Joint from Wind-Driven Rain
- » Easy Install = Decreased Labor Costs

PermaSpan Expansion Joints

VERSIONS

- Roof to Roof
- Roof to Wall
- 3-Axis Roof to Roof
- 3-Axis Roof to Wall

COVER MATERIALS

- 24 ga. Steel
- 22 ga. Steel
- .040" Aluminum
- .050" Aluminum
- .063" Aluminum

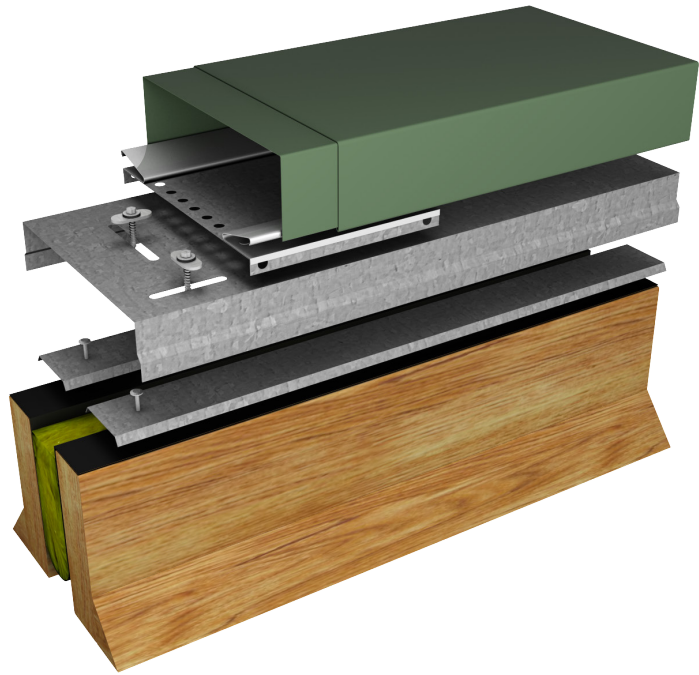

10 Express Colors for Quick Shipping

Express, standard, and premium colors and finishes are available to meet your job requirements and includes a 30-year Kynar 500® finish warranty on coil-coated standard colors. Custom colors are also available. For the most accurate color representation, contact us to request a paint chip.

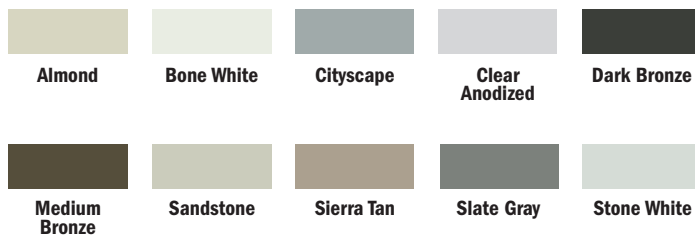

Also available in Mill Finish.

Easy and Efficient Installation

- » Provided in 12' lengths with pre-punched holes for quicker installation
- » Pre-punched fastening holes to ensure proper attachment to building substrate

HICKMAN
an MTL company

4 Commerce Way | Arden, NC 28704
(828) 676-1700 | www.hickmanedgesystems.com
Copyright ©2021. All rights reserved.

