

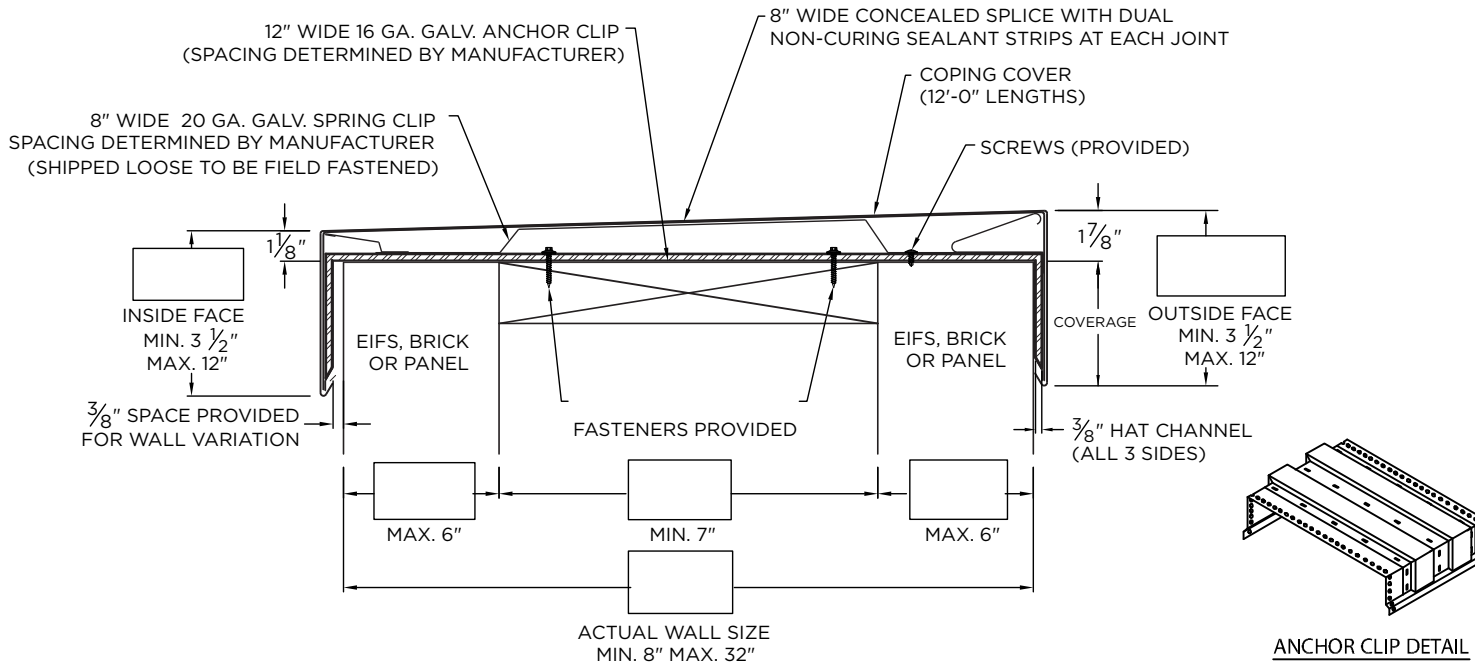

## SECUREDGE 200 DUAL CANTILEVER COPING



### \* NOTES

- 24 ga. Galv. and .040" Alum. Coping covers available for wall sizes 8" to 24" ONLY
- Oil canning can occur on larger face heights; recommend 22 ga., .050" or .063" for face height over 8"
- Unless otherwise noted, fabrication of miters and accessories are furnished standard utilizing a non-penetrating quicklock joint, then factory sealed watertight.
- Welded accessories require a minimum material thickness of .050"
- For non-90 miters, see separate print approval
- Product should be installed per provided installation instructions

### PROJECT INFO

Project Name: \_\_\_\_\_

Architect: \_\_\_\_\_

Roofing Contractor: \_\_\_\_\_

#### Project Type:

☐ By selecting this box you have verified and confirmed that dimensions, sizes, and quantities are correct. All products will be installed in strict accordance with printed instructions.

Date: \_\_\_\_\_

**Carlisle SynTec Systems**

Customer Service

866-458-3537

(Metal-Era)

SHT# 1 of 2

DATE: 06/13/23

DRN BY: JJC

CKD BY: MM

DWG #: 15011-21352

REV: C

### MATERIAL\*

☐ 24 Ga. Galv. Steel

Color: \_\_\_\_\_

☐ 22 Ga. Galv. Steel

Finish: \_\_\_\_\_

☐ .040" Aluminum

Substrate:

☐ .050" Aluminum

if substrate is not given, wood fasteners will be provided.

☐ .063" Aluminum

☐ Wood

☐ OTHER: \_\_\_\_\_

☐ Masonry

☐ Metal

### QUANTITIES

\_\_\_\_\_ Lineal Feet (12'-0" Lengths)

\_\_\_\_\_ Outside Miter (90°)

\_\_\_\_\_ Inside Miter (90°)

\_\_\_\_\_ Right Endcaps

\_\_\_\_\_ Left Endcaps

Accessory Type\* : ☐ Quicklock (Default) ☐ Welded (Surcharge)

\_\_\_\_\_ Right Endwall Flashing (Coping Version)

\_\_\_\_\_ Left Endwall Flashing (Coping Version)

\_\_\_\_\_ Right Endwall Flashing (Splice Plate Version)

\_\_\_\_\_ Left Endwall Flashing (Splice Plate Version)

# SECUREDGE 200 DUAL CANTILEVER COPING

## STANDARD ACCESSORIES

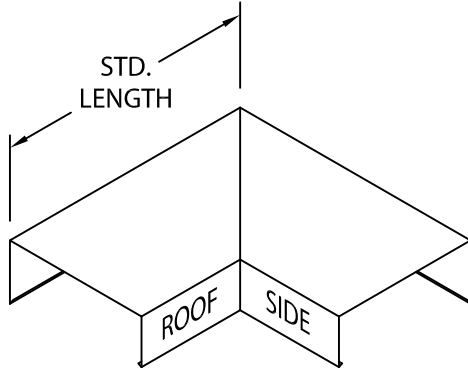

OUTSIDE MITER

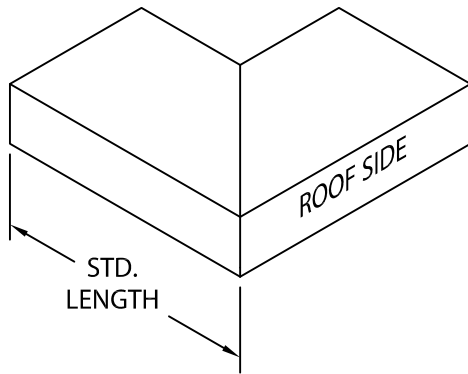

INSIDE MITER

MITER STANDARD LEG LENGTH:  
WALL SIZE + **10 3/8"** = LENGTH

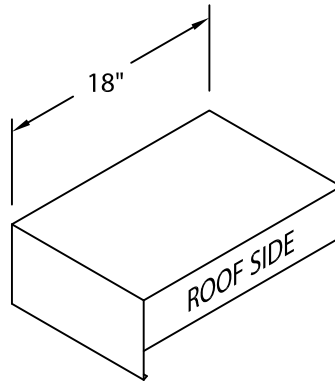

ENDCAP  
(LEFT HAND SHOWN)

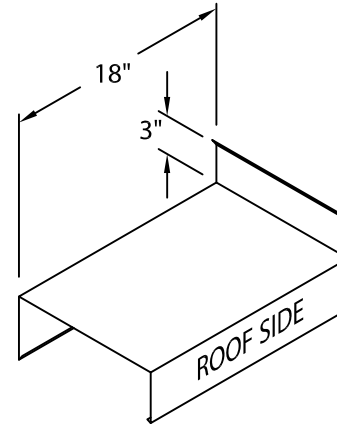

ENDWALL FLASHING  
COPING VERSION  
(RIGHT HAND SHOWN)

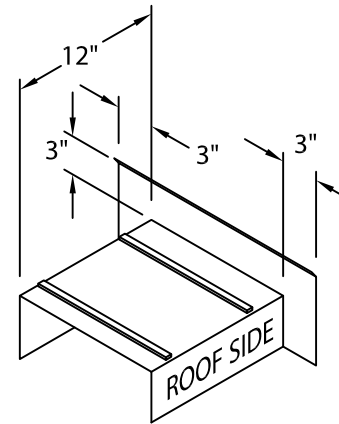

ENDWALL FLASHING  
SPLICE PLATE VERSION  
(RIGHT HAND SHOWN)  
(AVAILABLE ONLY IN  
.040" WELDED, PAINTED  
TO MATCH COPING)

## NOTES

Additional accessories are available including:

- Transition Miters
- Straight Transition Miters
- "T" Miters
- "Z" Miters
- Step-up Miters
- Peak / Valley Miters
- Pilaster Caps
- Radius Coping

For additional accessory requirements, attach sketches or call manufacturer for assistance.

SHT# 2 of 2

DATE: 06/13/23

DRN BY: JJC

CKD BY: MM

DWG #: 15011-21352

REV: C

**Carlisle SynTec Systems**  
Customer Service  
866-458-3537  
(Metal-Era)