

**THRU-WALL REGLET**  
2-PIECES

**NOTES**

- Pre-Notched Lap Joints
- No Fasteners Provided

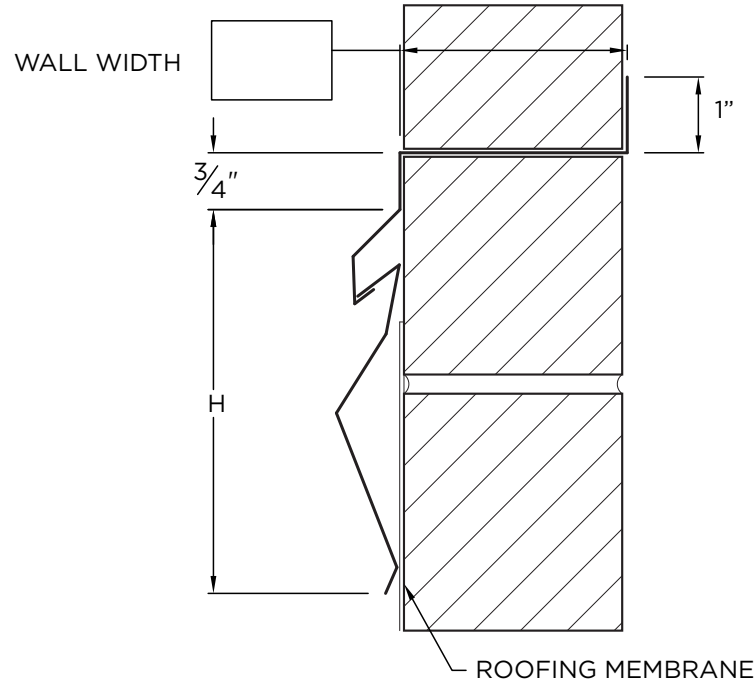

**PROJECT INFO**

Project Name: \_\_\_\_\_

Architect: \_\_\_\_\_

Roofing Contractor: \_\_\_\_\_

**Project Type:**

By selecting this box you have verified and confirmed that dimensions, sizes, and quantities are correct. All products will be installed in strict accordance with printed instructions.

Date: \_\_\_\_\_

**Hickman Edge Systems**  
4 Commerce Way  
Arden, NC 28704  
Phone: 828-676-1700  
www.hickmanedgesystems.com

SHT# 1 of 1

DATE: 02/01/ 22

DRN BY: JJC

CKD BY: MM

DWG #: 64015-37158

REV: A

**DIMENSIONS**

Choose H Dim and fill out wall width on drawing.

3.5" (CFTHRUWALL-350R)

4" (CFTHRUWALL-400R)

5" (CFTHRUWALL-500R)

**MATERIAL**

- 24 Ga. Galv. Steel
- .040" Aluminum
- .050" Aluminum

Color: \_\_\_\_\_

Finish: \_\_\_\_\_

OTHER: \_\_\_\_\_

**QUANTITIES**

\_\_\_\_\_ Lineal Feet (12'-0" Lengths)