

Offset Face Gutter

ORDER SPECIFICATION FORM

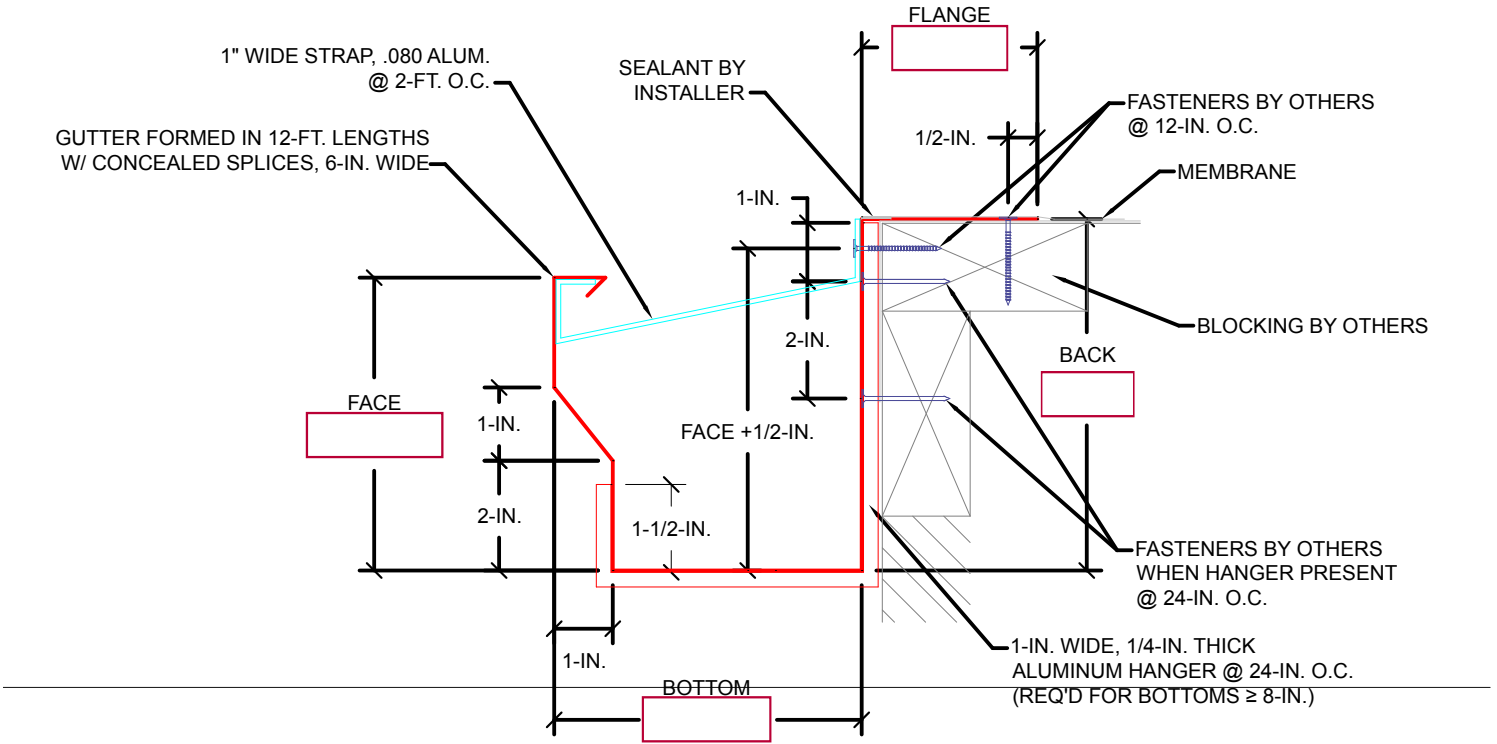

PLEASE CONTACT US FOR MASONRY APPLICATIONS.

CONTACT US FOR APPROPRIATE RECOMMENDATIONS NEEDED TO MEET/EXCEED
ANSI/SPRI/GT-1 DESIGN CRITERIA

| QUANTITY | CAP MATERIAL | THICKNESS | ACCESSORY TYPE | CAP FINISH |
|--|-----------------|-----------|----------------|---------------------------|
| ____ Total LF (12' pcs) | Aluminum | 0.040 | Welded | Mill Finish |
| ____ Miters (____ Outside, ____ Inside) | Galvanized | 0.050 | Meta-Lok | Prefinished Kynar |
| ____ End Caps (____ Left, ____ Right) | Stainless Steel | 0.063 | | Premium Prefinished Kynar |
| ____ Expansion Joints (End Caps) | | 0.080 | HANGERS | Post Finished Kynar |
| ____ End Cap Inserts (____ Left, ____ Right) | | 24 Ga. | Painted | Prefinished Anodized |
| ____ Expansion Joint Inserts | | 22 Ga. | Mill | Post Finished Anodized |
| ____ Radius LF (5'-0" pcs) | | | None | |
| ____ Radius to Straight Miter | COLOR | | | |
| ____ Radius End Caps | | | | |

| | | |
|--|---|----------------------|
| APPROVALS: Contact manufacturer for verification of test report data on your project. <div style="border: 1px solid black; padding: 5px; display: inline-block;">ANSI/SPRI/GT-1/Tested</div> | CUSTOMER APPROVAL Authorized Customer Signature | |
| | Approved for Fabrication Approved with Changes Not Approved | _____ Title Date |
| Job Name: _____ | Job #: _____ | By: _____ |
| Customer: _____ | Project Location: _____ | Date: _____ |
| Representative: _____ | Architect: _____ | Sheet _____ of _____ |

HICKMAN

EDGE SYSTEMS

Offset Face Gutter with Roof Flange.

ORDER SPECIFICATION FORM

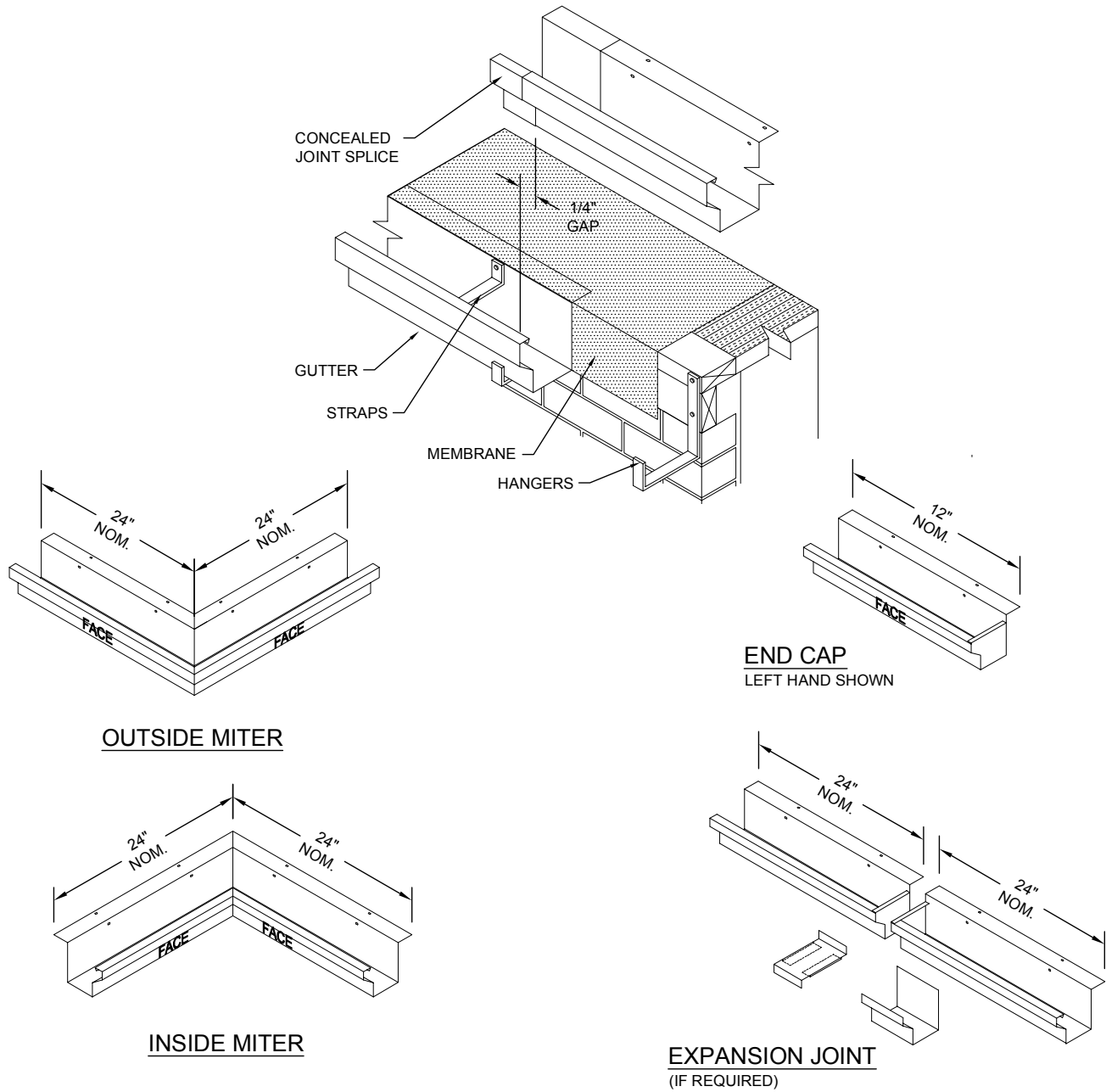

Standard gutter miter leg lengths are 24" Nominal
Standard gutter miter angle is 90°
For special miter requirements, attach sketches or consult manufacturer for assistance.

HICKMAN

EDGE SYSTEMS

4 Commerce Way | Arden, NC 28704
(800) 892-9173 | (828) 676-1700 | HickmanEdgeSystems.com
Copyright ©2021. All rights reserved.

Superior productivity.
Superior performance.

