

COPING TRANSITION CONDITIONS

BACK LEG OFFSET TRANSITION CONDITION

*WALL SIZE SHALL INCLUDE INSTALLED MEMBRANE THICKNESS

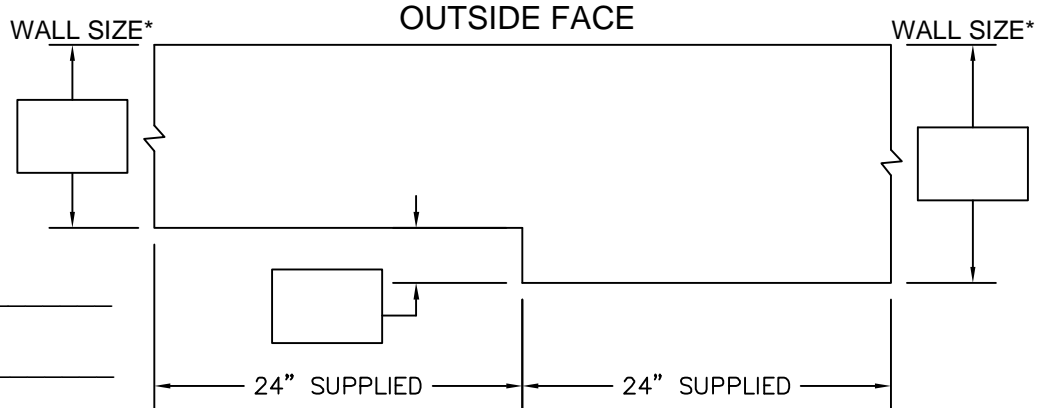

UNIQUE ID _____

FACE LEG SIZE _____

BACK LEG SIZE _____

QUANTITY _____

- WELDED
 QUICKLOCK

FACE LEG OFFSET TRANSITION CONDITION

*WALL SIZE SHALL INCLUDE INSTALLED MEMBRANE THICKNESS

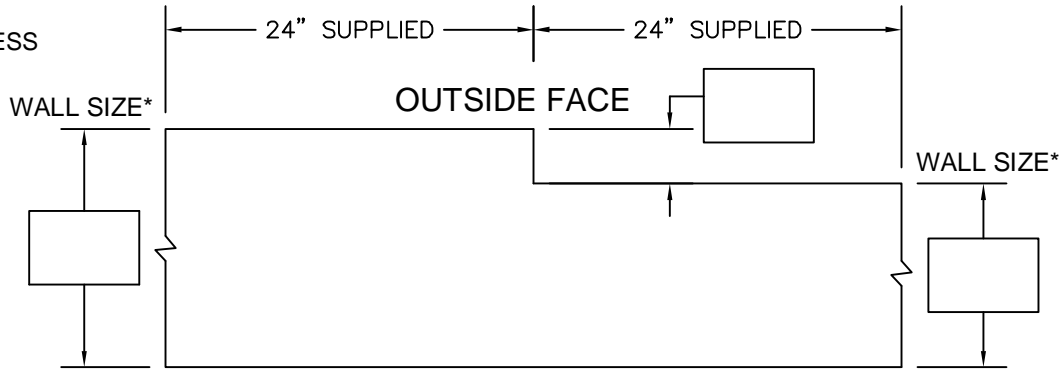

FACE LEG SIZE _____ UNIQUE ID _____

BACK LEG SIZE _____ QUANTITY _____

- WELDED
 QUICKLOCK

COPING:

- PERMASNAP PREMIER PLUS
- PERMASNAP PREMIER
- PERMASNAP PLUS
- PERMASNAP
- PERMASNAP CONTINUOUS CLEAT
- PERMASNAP CANTILEVER
- PERMASNAP DOUBLE SLOPE
- OTHER

MATERIALS:

METAL-LOCKED	WELDED
24 GA GALVANIZED STEEL	.050" ALUMINUM
22 GA GALVANIZED STEEL	.063" ALUMINUM
.040" ALUMINUM	
.050" ALUMINUM	
.063" ALUMINUM	

FINISH:

QUICKLOCK	WELDED
PRE-FINISHED KYNAR	2-COAT STANDARD
PRE-ANODIZED	3-COAT STANDARD
	PRE-ANODIZED
	POST-ANODIZED

COLOR: _____

CUSTOMER APPROVAL TO PROCEED

CUSTOMER OR CUSTOMER REPRESENTATIVE SHALL VERIFY ALL DIMENSIONS, COLOR(S), AND QUANTITIES. INSTALLATION SHALL BE PERFORMED IN STRICT ACCORDANCE WITH OUR INSTALLATION INSTRUCTIONS.

CUSTOMER REPRESENTATIVE: _____

COMPANY: _____

DATE/PROJECT: _____

NOTE: PLEASE REVIEW PROJECT DRAWINGS FOR CLARIFICATION OF ADDITIONAL INFORMATION. FABRICATION WILL PROCEED UPON SIGNED CUSTOMER APPROVAL.

COPING Z CONDITIONS

HORIZONTAL Z CONDITION 1

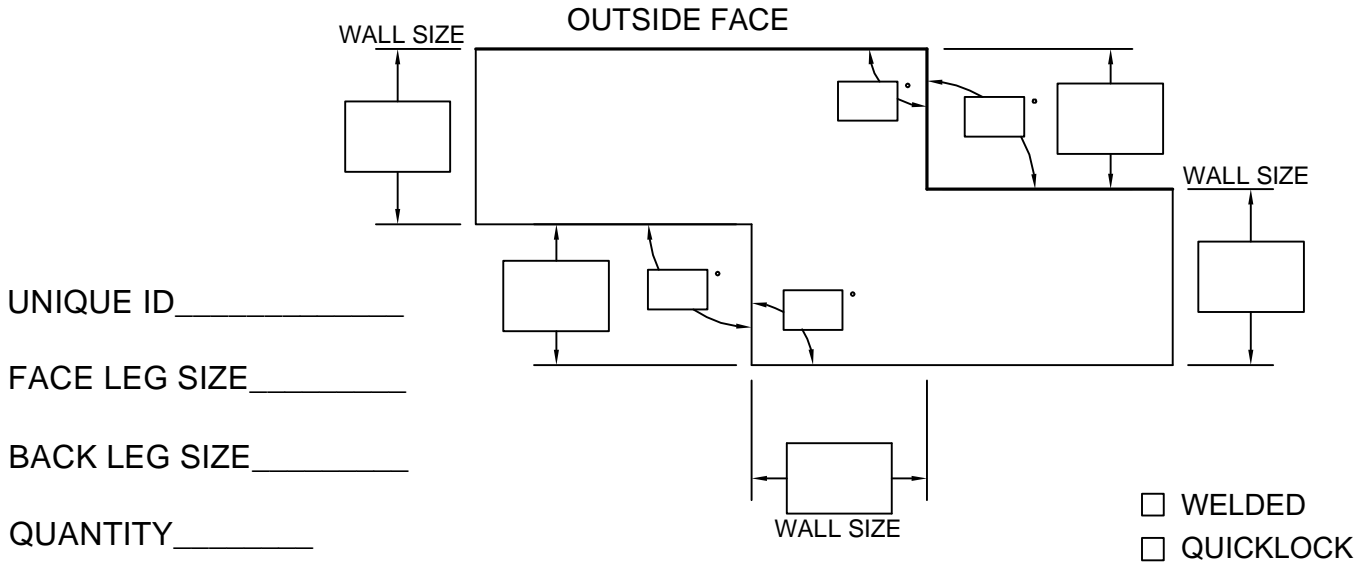

HORIZONTAL Z CONDITION 2

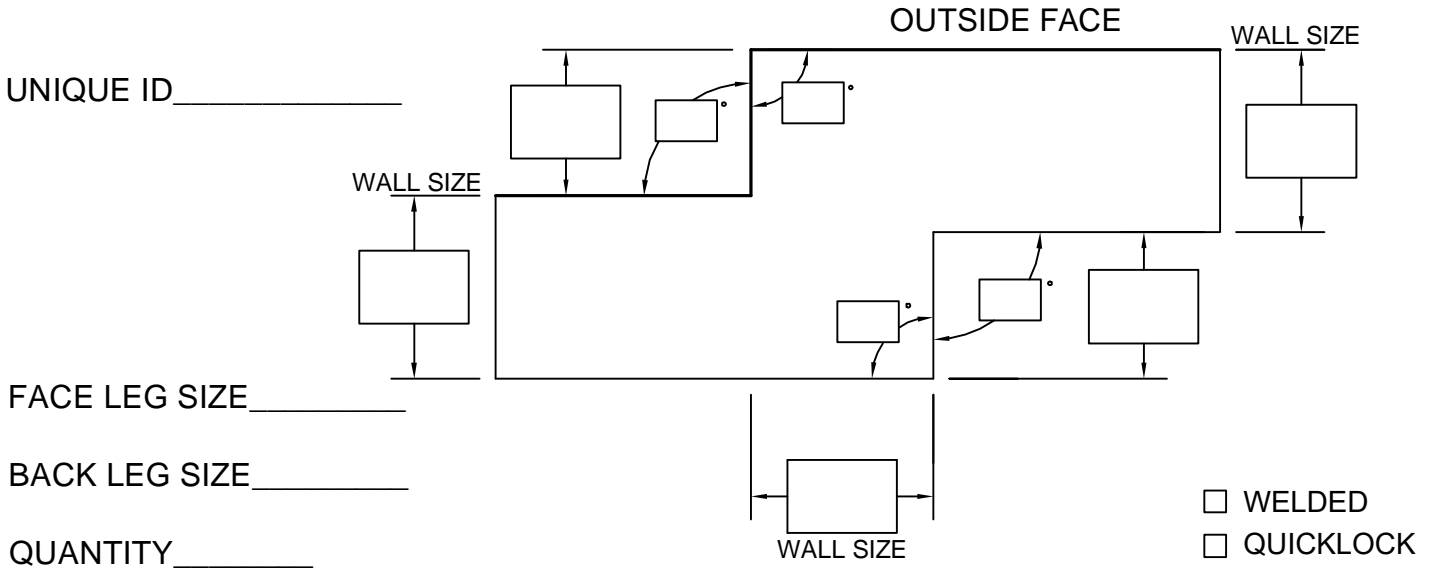

COPING:

PERMASNAP PREMIER PLUS
 PERMASNAP PREMIER
 PERMASNAP PLUS
 PERMASNAP
 PERMASNAP CONTINUOUS CLEAT
 PERMASNAP CANTILEVER
 PERMASNAP DOUBLE SLOPE
 OTHER

MATERIALS:

METAL-LOCKED

24 GA GALVANIZED STEEL
 22 GA GALVANIZED STEEL
 .040" ALUMINUM
 .050" ALUMINUM
 .063" ALUMINUM

WELDED

.050" ALUMINUM
 .063" ALUMINUM

FINISH:

QUICKLOCK

PRE-FINISHED KYNAR
 PRE-ANODIZED

WELDED

2-COAT STANDARD
 3-COAT STANDARD
 PRE-ANODIZED
 POST-ANODIZED

COLOR: _____

CUSTOMER APPROVAL TO PROCEED

CUSTOMER OR CUSTOMER REPRESENTATIVE SHALL VERIFY ALL DIMENSIONS, COLOR(S), AND QUANTITIES.
 INSTALLATION SHALL BE PERFORMED IN STRICT ACCORDANCE WITH OUR INSTALLATION INSTRUCTIONS.

CUSTOMER REPRESENTATIVE: _____

COMPANY: _____

DATE/PROJECT: _____

NOTE: PLEASE REVIEW PROJECT DRAWINGS FOR CLARIFICATION OF ADDITIONAL INFORMATION. FABRICATION WILL PROCEED UPON SIGNED CUSTOMER APPROVAL.

COPING CORNER CONDITIONS

OUTSIDE CORNER

SUPPLIED LEG LENGTHS:
 OUTSIDE FACE=
 23.25" FOR WALLS ≤16"
 29.25" FOR WALLS >16", ≤23"
 CUSTOM FOR WALLS >23"

*WALL SIZE SHALL
 INCLUDE INSTALLED
 MEMBRANE THICKNESS

UNIQUE ID _____

FACE LEG SIZE _____

BACK LEG SIZE _____

QUANTITY _____

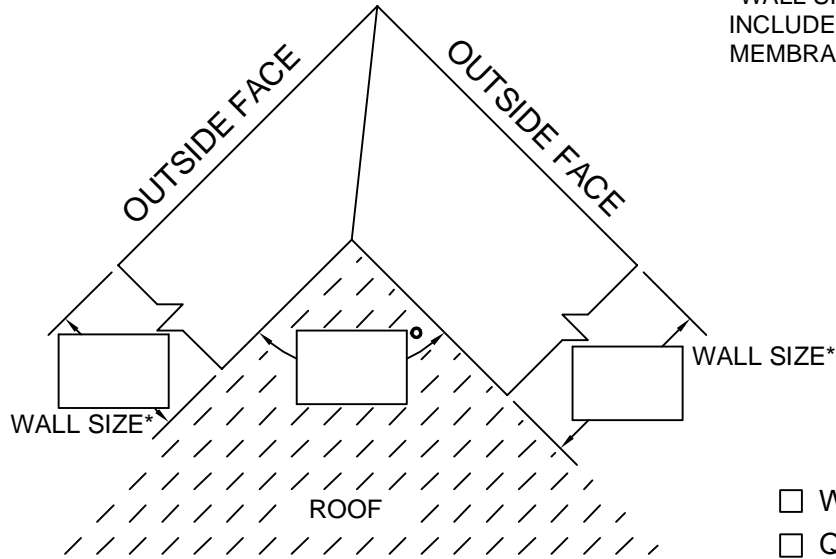

WELDED
 QUICKLOCK

INSIDE CORNER

SUPPLIED LEG LENGTHS:
 INSIDE FACE=
 23.25" FOR WALLS ≤16"
 29.25" FOR WALLS >16", ≤23"
 CUSTOM FOR WALLS >23"

UNIQUE ID _____

FACE LEG SIZE _____

BACK LEG SIZE _____

QUANTITY _____

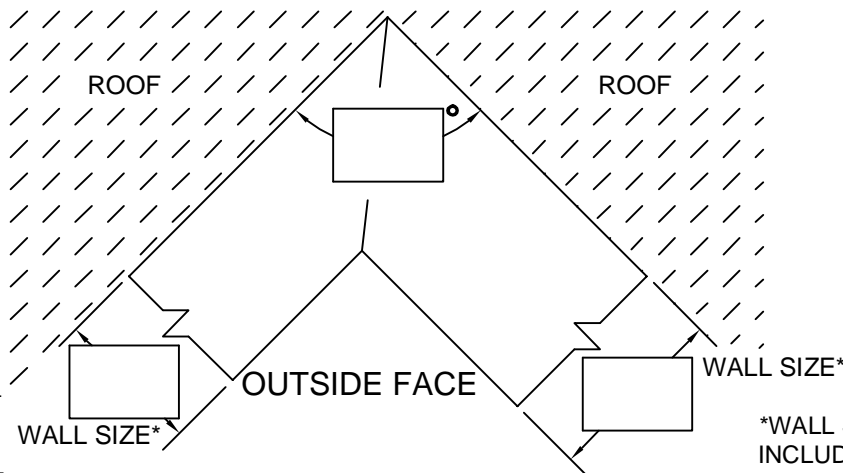

*WALL SIZE SHALL
 INCLUDE INSTALLED
 MEMBRANE THICKNESS

WELDED
 QUICKLOCK

COPING:

PERMASNAP PREMIER PLUS
 PERMASNAP PREMIER
 PERMASNAP PLUS
 PERMASNAP
 PERMASNAP CONTINUOUS CLEAT
 PERMASNAP CANTILEVER
 PERMASNAP DOUBLE SLOPE
 OTHER

MATERIALS:

METAL-LOCKED

24 GA GALVANIZED STEEL
 22 GA GALVANIZED STEEL
 .040" ALUMINUM
 .050" ALUMINUM
 .063" ALUMINUM

WELDED

.050" ALUMINUM
 .063" ALUMINUM

FINISH:

QUICKLOCK

PRE-FINISHED KYNAR
 PRE-ANODIZED

WELDED

2-COAT STANDARD
 3-COAT STANDARD
 PRE-ANODIZED
 POST-ANODIZED

COLOR: _____

CUSTOMER APPROVAL TO PROCEED

CUSTOMER OR CUSTOMER REPRESENTATIVE SHALL VERIFY ALL DIMENSIONS, COLOR(S), AND QUANTITIES.
 INSTALLATION SHALL BE PERFORMED IN STRICT ACCORDANCE WITH OUR INSTALLATION INSTRUCTIONS.

CUSTOMER REPRESENTATIVE: _____

COMPANY: _____

DATE/PROJECT: _____

NOTE: PLEASE REVIEW PROJECT DRAWINGS FOR CLARIFICATION OF ADDITIONAL INFORMATION. FABRICATION WILL PROCEED UPON SIGNED CUSTOMER APPROVAL.

COPING TRANSITION CONDITIONS

TYPICAL OUTSIDE TEE TRANSITION CONDITION

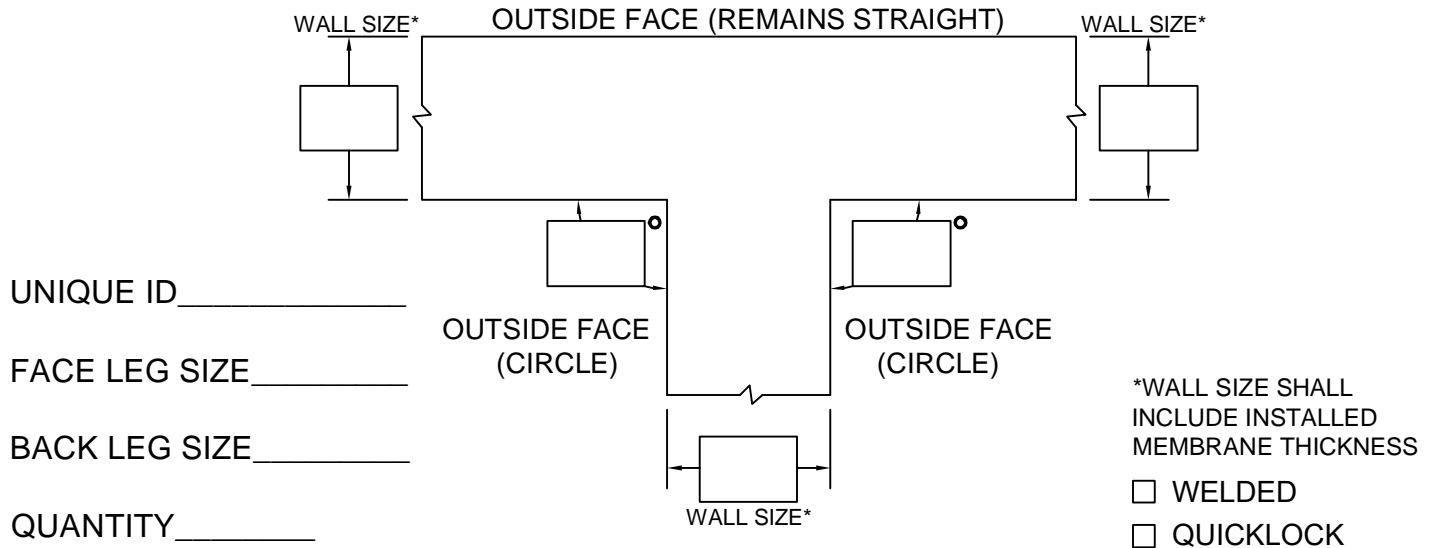

TYPICAL INSIDE TEE TRANSITION CONDITION

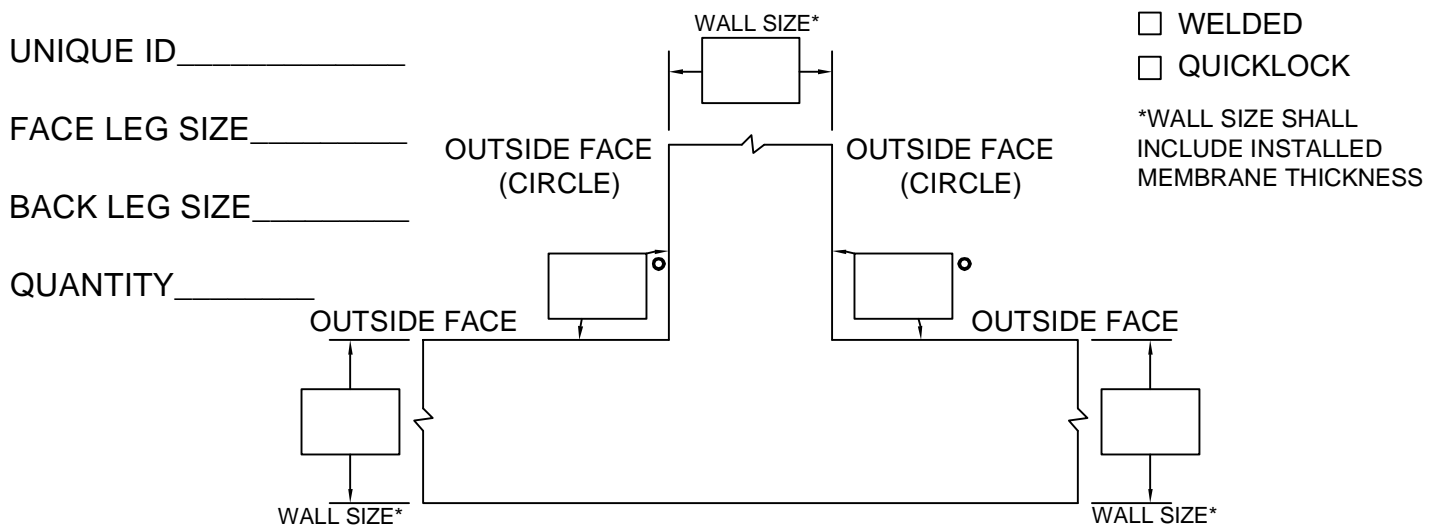

COPING:

- PERMASNAP PREMIER PLUS
- PERMASNAP PREMIER
- PERMASNAP PLUS
- PERMASNAP
- PERMASNAP CONTINUOUS CLEAT
- PERMASNAP CANTILEVER
- PERMASNAP DOUBLE SLOPE
- OTHER

MATERIALS:

METAL-LOCKED

- 24 GA GALVANIZED STEEL
- 22 GA GALVANIZED STEEL
- .040" ALUMINUM
- .050" ALUMINUM
- .063" ALUMINUM

WELDED

- .050" ALUMINUM
- .063" ALUMINUM

FINISH:

QUICKLOCK

- PRE-FINISHED KYNAR
- PRE-ANODIZED

WELDED

- 2-COAT STANDARD
- 3-COAT STANDARD
- PRE-ANODIZED
- POST-ANODIZED

COLOR: _____

CUSTOMER APPROVAL TO PROCEED

CUSTOMER OR CUSTOMER REPRESENTATIVE SHALL VERIFY ALL DIMENSIONS, COLOR(S), AND QUANTITIES. INSTALLATION SHALL BE PERFORMED IN STRICT ACCORDANCE WITH OUR INSTALLATION INSTRUCTIONS.

CUSTOMER REPRESENTATIVE: _____

COMPANY: _____

DATE/PROJECT: _____

NOTE: PLEASE REVIEW PROJECT DRAWINGS FOR CLARIFICATION OF ADDITIONAL INFORMATION. FABRICATION WILL PROCEED UPON SIGNED CUSTOMER APPROVAL.

RIDGE AND VALLEY CONDITIONS

RIDGE CONDITION

UNIQUE ID _____

WALL SIZE LEFT _____

WALL SIZE RIGHT _____

FACE LEG SIZE _____

BACK LEG SIZE _____

QUANTITY _____

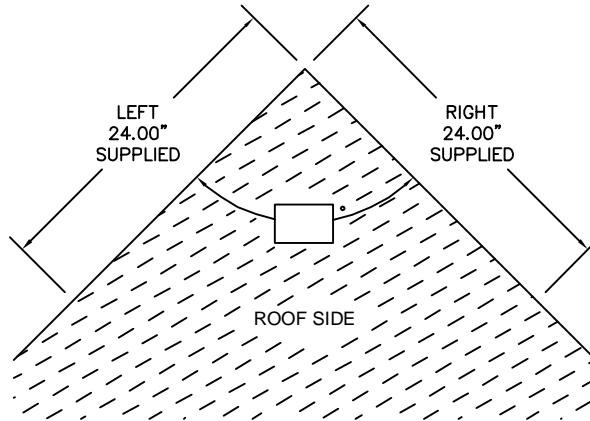

- WELDED
 QUICKLOCK

VALLEY CONDITION

UNIQUE ID _____

WALL SIZE LEFT _____

WALL SIZE RIGHT _____

FACE LEG SIZE _____

BACK LEG SIZE _____

QUANTITY _____

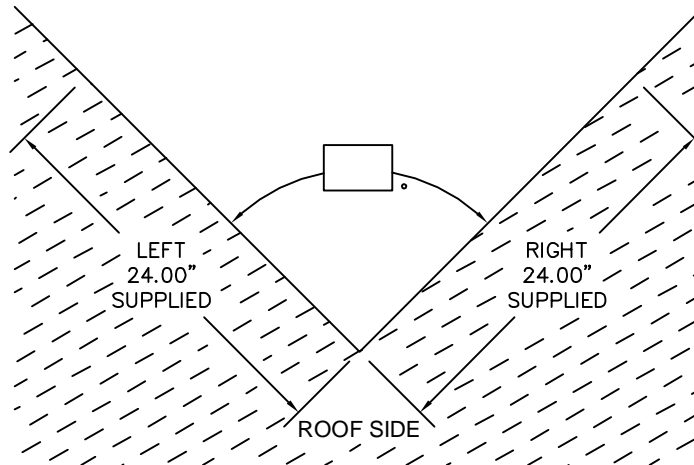

- WELDED
 QUICKLOCK

COPING:

- PERMASNAP PREMIER PLUS
- PERMASNAP PREMIER
- PERMASNAP PLUS
- PERMASNAP
- PERMASNAP CONTINUOUS CLEAT
- PERMASNAP CANTILEVER
- PERMASNAP DOUBLE SLOPE
- OTHER

MATERIALS:

METAL-LOCKED

- 24 GA GALVANIZED STEEL
- 22 GA GALVANIZED STEEL
- .040" ALUMINUM
- .050" ALUMINUM
- .063" ALUMINUM

WELDED

- .050" ALUMINUM
- .063" ALUMINUM

FINISH:

QUICKLOCK

- PRE-FINISHED KYNAR
- PRE-ANODIZED

WELDED

- 2-COAT STANDARD
- 3-COAT STANDARD
- PRE-ANODIZED
- POST-ANODIZED

COLOR: _____

CUSTOMER APPROVAL TO PROCEED

CUSTOMER OR CUSTOMER REPRESENTATIVE SHALL VERIFY ALL DIMENSIONS, COLOR(S), AND QUANTITIES.
 INSTALLATION SHALL BE PERFORMED IN STRICT ACCORDANCE WITH OUR INSTALLATION INSTRUCTIONS.

CUSTOMER REPRESENTATIVE: _____

COMPANY: _____

DATE/PROJECT: _____

NOTE: PLEASE REVIEW PROJECT DRAWINGS FOR CLARIFICATION OF ADDITIONAL INFORMATION. FABRICATION WILL PROCEED UPON SIGNED CUSTOMER APPROVAL.

COPING PROJECT WALL CONDITION

FLAT WALL CONDITION

UNIQUE ID _____
 FACE LEG SIZE _____
 BACK LEG SIZE _____
 QUANTITY _____

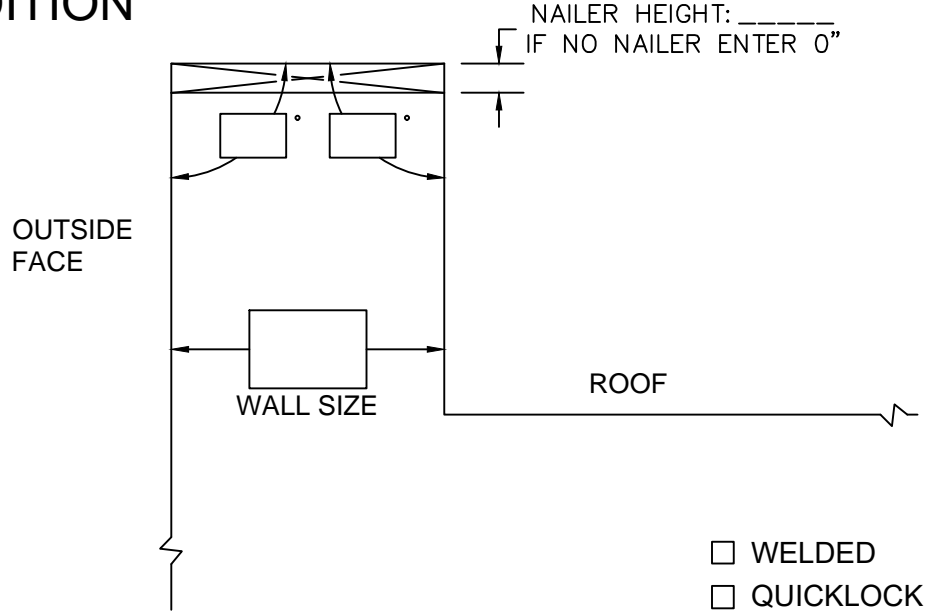

WELDED
 QUICKLOCK

SLOPED WALL CONDITION

UNIQUE ID _____
 FACE LEG SIZE _____
 BACK LEG SIZE _____
 QUANTITY _____

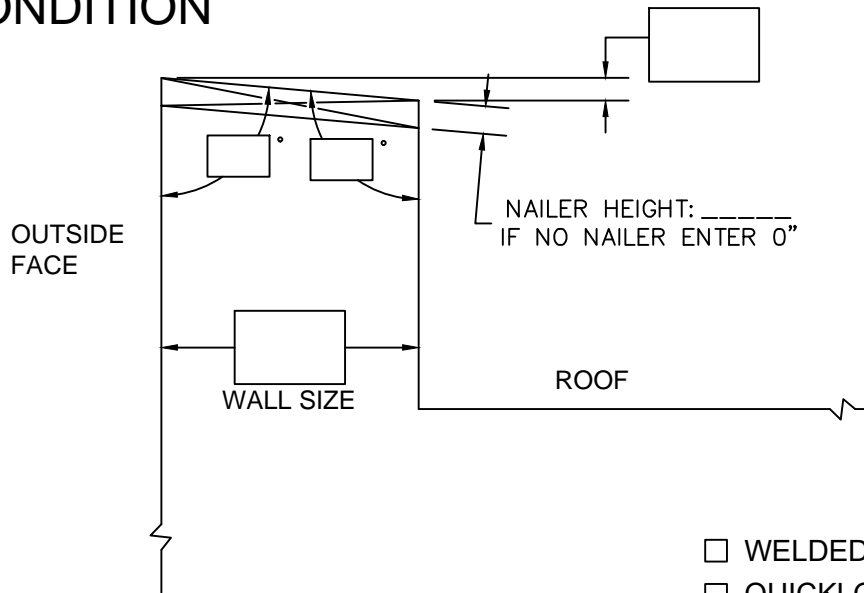

WELDED
 QUICKLOCK

COPING:

PERMASNAP PREMIER PLUS
 PERMASNAP PREMIER
 PERMASNAP PLUS
 PERMASNAP
 PERMASNAP CONTINUOUS CLEAT
 PERMASNAP CANTILEVER
 PERMASNAP DOUBLE SLOPE
 OTHER

MATERIALS:

METAL-LOCKED	WELDED
24 GA GALVANIZED STEEL	.050" ALUMINUM
22 GA GALVANIZED STEEL	.063" ALUMINUM
.040" ALUMINUM	
.050" ALUMINUM	
.063" ALUMINUM	

FINISH:

QUICKLOCK	WELDED
PRE-FINISHED KYNAR	2-COAT STANDARD
PRE-ANODIZED	3-COAT STANDARD
	PRE-ANODIZED
	POST-ANODIZED

COLOR: _____

CUSTOMER APPROVAL TO PROCEED

CUSTOMER OR CUSTOMER REPRESENTATIVE SHALL VERIFY ALL DIMENSIONS, COLOR(S), AND QUANTITIES.
 INSTALLATION SHALL BE PERFORMED IN STRICT ACCORDANCE WITH OUR INSTALLATION INSTRUCTIONS.

CUSTOMER REPRESENTATIVE: _____

COMPANY: _____

DATE/PROJECT: _____

NOTE: PLEASE REVIEW PROJECT DRAWINGS FOR CLARIFICATION OF ADDITIONAL INFORMATION. FABRICATION WILL PROCEED UPON SIGNED CUSTOMER APPROVAL.

COPING Z CONDITIONS

VERTICAL Z CONDITION 1

UNIQUE ID _____

FACE LEG SIZE _____

BACK LEG SIZE _____

QUANTITY _____

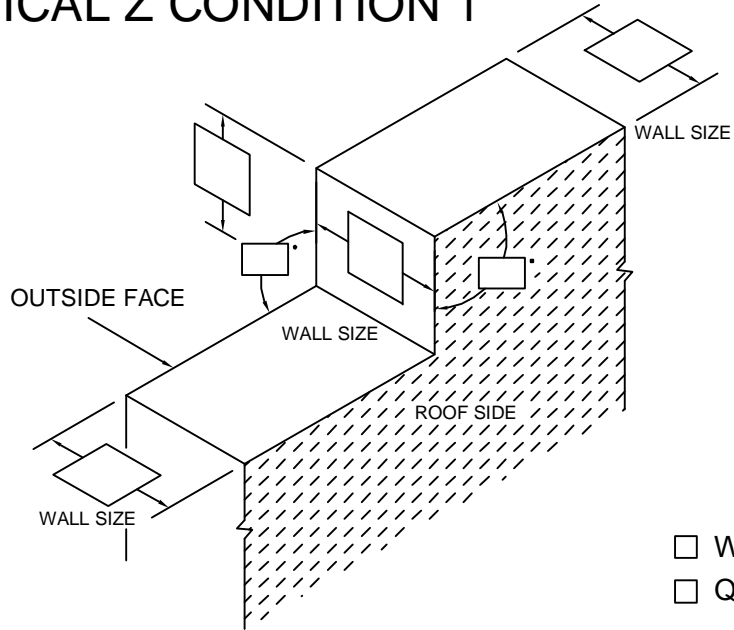

VERTICAL Z CONDITION 2

UNIQUE ID _____

FACE LEG SIZE _____

BACK LEG SIZE _____

QUANTITY _____

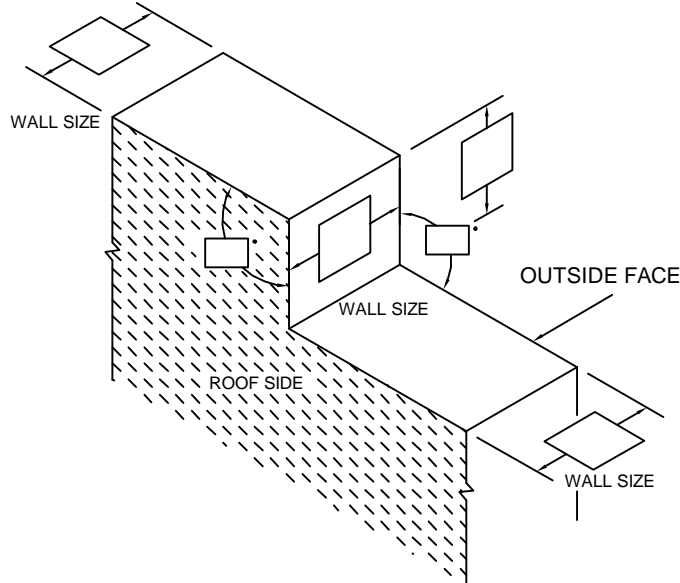

COPING:

- PERMASNAP PREMIER PLUS
- PERMASNAP PREMIER
- PERMASNAP PLUS
- PERMASNAP
- PERMASNAP CONTINUOUS CLEAT
- PERMASNAP CANTILEVER
- PERMASNAP DOUBLE SLOPE
- OTHER

MATERIALS:

METAL-LOCKED

- 24 GA GALVANIZED STEEL
- 22 GA GALVANIZED STEEL
- .040" ALUMINUM
- .050" ALUMINUM
- .063" ALUMINUM

WELDED

- .050" ALUMINUM
- .063" ALUMINUM

FINISH:

QUICKLOCK

- PRE-FINISHED KYNAR
- PRE-ANODIZED

WELDED

- 2-COAT STANDARD
- 3-COAT STANDARD
- PRE-ANODIZED
- POST-ANODIZED

COLOR: _____

CUSTOMER APPROVAL TO PROCEED

CUSTOMER OR CUSTOMER REPRESENTATIVE SHALL VERIFY ALL DIMENSIONS, COLOR(S), AND QUANTITIES. INSTALLATION SHALL BE PERFORMED IN STRICT ACCORDANCE WITH OUR INSTALLATION INSTRUCTIONS.

CUSTOMER REPRESENTATIVE: _____

COMPANY: _____

DATE/PROJECT: _____

NOTE: PLEASE REVIEW PROJECT DRAWINGS FOR CLARIFICATION OF ADDITIONAL INFORMATION. FABRICATION WILL PROCEED UPON SIGNED CUSTOMER APPROVAL.

COPING RADIUS CONDITIONS

OUTSIDE RADIUS CONDITION

Diagram illustrating the Outside Radius Condition. The diagram shows a curved profile with the following labels: **OUTSIDE FACE** (top outer curve), **RISE** (vertical distance from chord to peak), **CHORD** (horizontal distance across the curve), **RADIUS** (distance from center of curvature to the curve), and **ROOF SIDE** (hatched area below the curve). A box is provided for the RISE dimension.

UNIQUE ID _____
 WALL WIDTH _____
 FACE LEG SIZE _____
 BACK LEG SIZE _____
 LINEAR FEET _____ ENTER RADIUS OR CHORD AND RISE

WELDED
 QUICKLOCK

INSIDE RADIUS CONDITION

Diagram illustrating the Inside Radius Condition. The diagram shows a curved profile with the following labels: **OUTSIDE FACE** (top outer curve), **RADIUS** (distance from center of curvature to the curve), **CHORD** (horizontal distance across the curve), **RISE** (vertical distance from chord to peak), and **ROOF SIDE** (hatched area below the curve). A box is provided for the RADIUS dimension.

UNIQUE ID _____
 WALL WIDTH _____
 FACE LEG SIZE _____
 BACK LEG SIZE _____
 LINEAR FEET _____ ENTER RADIUS OR CHORD AND RISE

WELDED
 QUICKLOCK

COPING:

PERMASNAP PREMIER PLUS
 PERMASNAP PREMIER
 PERMASNAP PLUS
 PERMASNAP
 PERMASNAP CONTINUOUS CLEAT
 PERMASNAP CANTILEVER
 PERMASNAP DOUBLE SLOPE
 OTHER

MATERIALS:

METAL-LOCKED

24 GA GALVANIZED STEEL
 22 GA GALVANIZED STEEL
 .040" ALUMINUM
 .050" ALUMINUM
 .063" ALUMINUM

WELDED

.050" ALUMINUM
 .063" ALUMINUM

FINISH:

QUICKLOCK

PRE-FINISHED KYNAR
 PRE-ANODIZED

WELDED

2-COAT STANDARD
 3-COAT STANDARD
 PRE-ANODIZED
 POST-ANODIZED

COLOR: _____

CUSTOMER APPROVAL TO PROCEED

CUSTOMER OR CUSTOMER REPRESENTATIVE SHALL VERIFY ALL DIMENSIONS, COLOR(S), AND QUANTITIES.
 INSTALLATION SHALL BE PERFORMED IN STRICT ACCORDANCE WITH OUR INSTALLATION INSTRUCTIONS.

CUSTOMER REPRESENTATIVE: _____

COMPANY: _____

DATE/PROJECT: _____

NOTE: PLEASE REVIEW PROJECT DRAWINGS FOR CLARIFICATION OF ADDITIONAL INFORMATION. FABRICATION WILL PROCEED UPON SIGNED CUSTOMER APPROVAL.

COPING VAULT CONDITIONS

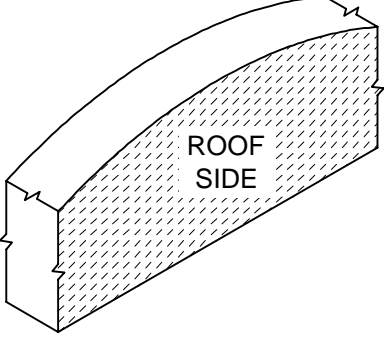

ROOF SIDE

UNIQUE ID _____

WALL WIDTH _____

FACE LEG SIZE _____

BACK LEG SIZE _____

LINEAR FEET _____

VAULT CONDITION

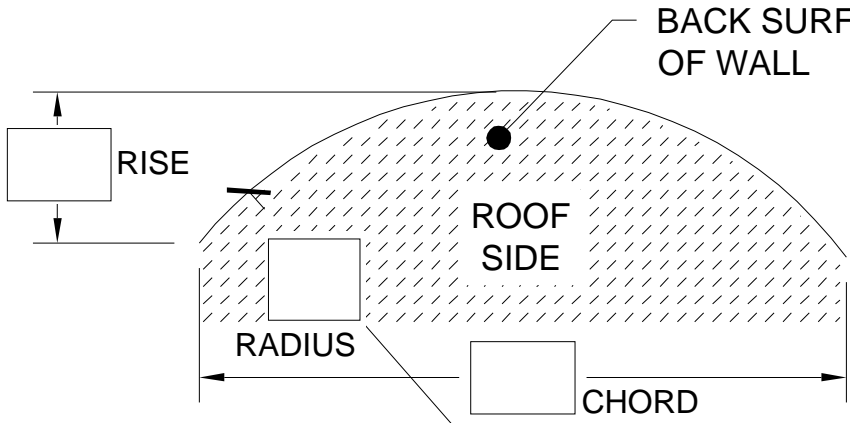

ENTER RADIUS OR CHORD AND RISE

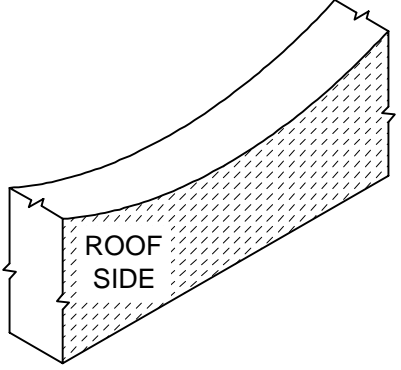

ROOF SIDE

UNIQUE ID _____

WALL WIDTH _____

FACE LEG SIZE _____

BACK LEG SIZE _____

LINEAR FEET _____

INSIDE RADIUS CONDITION

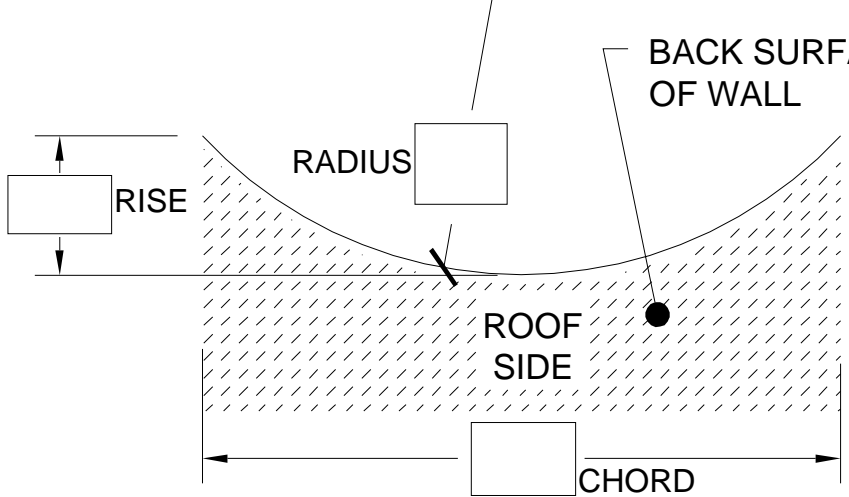

ENTER RADIUS OR CHORD AND RISE

<p>COPING:</p> <ul style="list-style-type: none"> PERMASNAP PREMIER PLUS PERMASNAP PREMIER PERMASNAP PLUS PERMASNAP PERMASNAP CONTINUOUS CLEAT PERMASNAP CANTILEVER PERMASNAP DOUBLE SLOPE OTHER 	<p>MATERIALS:</p> <table style="width: 100%; border: none;"> <tr> <td style="text-align: center;">METAL-LOCKED</td> <td style="text-align: center;">WELDED</td> </tr> <tr> <td>24 GA GALVANIZED STEEL</td> <td>.050" ALUMINUM</td> </tr> <tr> <td>22 GA GALVANIZED STEEL</td> <td>.063" ALUMINUM</td> </tr> <tr> <td>.040" ALUMINUM</td> <td></td> </tr> <tr> <td>.050" ALUMINUM</td> <td></td> </tr> <tr> <td>.063" ALUMINUM</td> <td></td> </tr> </table>	METAL-LOCKED	WELDED	24 GA GALVANIZED STEEL	.050" ALUMINUM	22 GA GALVANIZED STEEL	.063" ALUMINUM	.040" ALUMINUM		.050" ALUMINUM		.063" ALUMINUM		<p>FINISH:</p> <table style="width: 100%; border: none;"> <tr> <td style="text-align: center;">QUICKLOCK</td> <td style="text-align: center;">WELDED</td> </tr> <tr> <td>PRE-FINISHED KYNAR</td> <td>2-COAT STANDARD</td> </tr> <tr> <td>PRE-ANODIZED</td> <td>3-COAT STANDARD</td> </tr> <tr> <td></td> <td>PRE-ANODIZED</td> </tr> <tr> <td></td> <td>POST-ANODIZED</td> </tr> </table> <p>COLOR: _____</p>	QUICKLOCK	WELDED	PRE-FINISHED KYNAR	2-COAT STANDARD	PRE-ANODIZED	3-COAT STANDARD		PRE-ANODIZED		POST-ANODIZED
METAL-LOCKED	WELDED																							
24 GA GALVANIZED STEEL	.050" ALUMINUM																							
22 GA GALVANIZED STEEL	.063" ALUMINUM																							
.040" ALUMINUM																								
.050" ALUMINUM																								
.063" ALUMINUM																								
QUICKLOCK	WELDED																							
PRE-FINISHED KYNAR	2-COAT STANDARD																							
PRE-ANODIZED	3-COAT STANDARD																							
	PRE-ANODIZED																							
	POST-ANODIZED																							

CUSTOMER APPROVAL TO PROCEED

CUSTOMER OR CUSTOMER REPRESENTATIVE SHALL VERIFY ALL DIMENSIONS, COLOR(S), AND QUANTITIES. INSTALLATION SHALL BE PERFORMED IN STRICT ACCORDANCE WITH OUR INSTALLATION INSTRUCTIONS.

CUSTOMER REPRESENTATIVE: _____

COMPANY: _____

DATE/PROJECT: _____

NOTE: PLEASE REVIEW PROJECT DRAWINGS FOR CLARIFICATION OF ADDITIONAL INFORMATION. FABRICATION WILL PROCEED UPON SIGNED CUSTOMER APPROVAL.

ENDCAPS

RIGHT-HAND ENDCAP

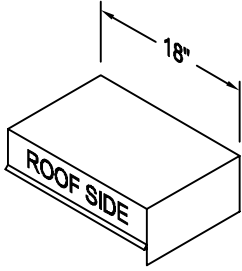

UNIQUE ID _____

FACE LEG SIZE _____

BACK LEG SIZE _____

QUANTITY _____

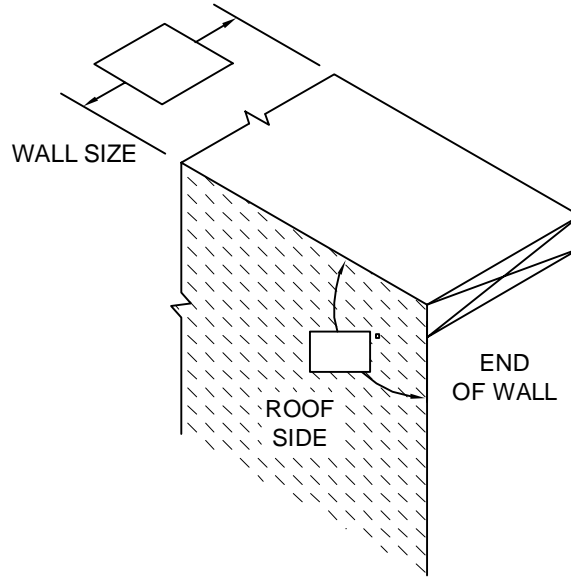

- WELDED
 QUICKLOCK

LEFT-HAND ENDCAP

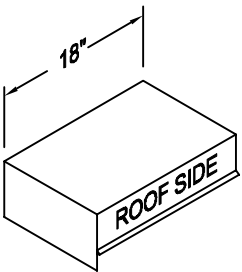

UNIQUE ID _____

FACE LEG SIZE _____

BACK LEG SIZE _____

QUANTITY _____

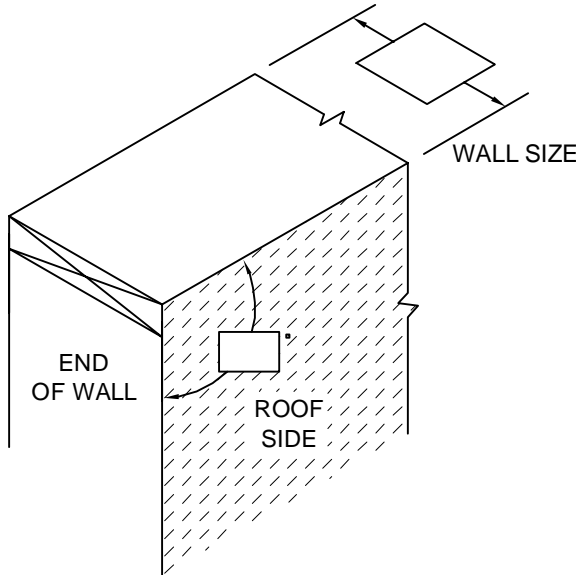

- WELDED
 QUICKLOCK

COPING:

- PERMASNAP PREMIER PLUS
- PERMASNAP PREMIER
- PERMASNAP PLUS
- PERMASNAP
- PERMASNAP CONTINUOUS CLEAT
- PERMASNAP CANTILEVER
- PERMASNAP DOUBLE SLOPE
- OTHER

MATERIALS:

METAL-LOCKED

- 24 GA GALVANIZED STEEL
- 22 GA GALVANIZED STEEL
- .040" ALUMINUM
- .050" ALUMINUM
- .063" ALUMINUM

WELDED

- .050" ALUMINUM
- .063" ALUMINUM

FINISH:

QUICKLOCK

- PRE-FINISHED KYNAR
- PRE-ANODIZED

WELDED

- 2-COAT STANDARD
- 3-COAT STANDARD
- PRE-ANODIZED
- POST-ANODIZED

COLOR: _____

CUSTOMER APPROVAL TO PROCEED

CUSTOMER OR CUSTOMER REPRESENTATIVE SHALL VERIFY ALL DIMENSIONS, COLOR(S), AND QUANTITIES. INSTALLATION SHALL BE PERFORMED IN STRICT ACCORDANCE WITH OUR INSTALLATION INSTRUCTIONS.

CUSTOMER REPRESENTATIVE: _____

COMPANY: _____

DATE/PROJECT: _____

NOTE: PLEASE REVIEW PROJECT DRAWINGS FOR CLARIFICATION OF ADDITIONAL INFORMATION. FABRICATION WILL PROCEED UPON SIGNED CUSTOMER APPROVAL.

ENDWALL FLASHING

RIGHT-HAND ENDWALL (COPING VERSION)

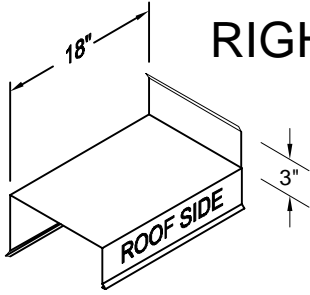

UNIQUE ID _____

FACE LEG SIZE _____

BACK LEG SIZE _____

QUANTITY _____

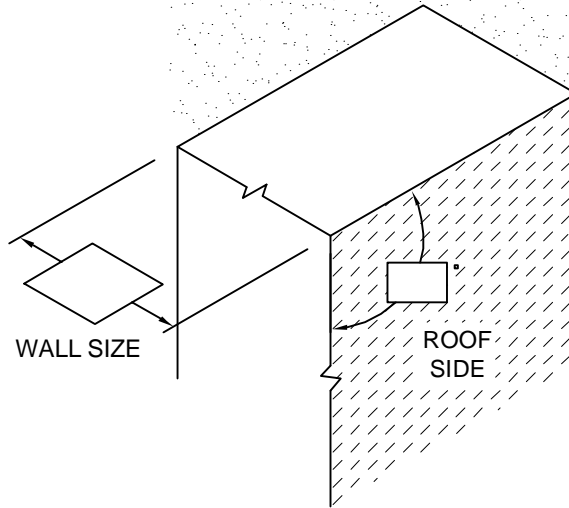

- WELDED
 QUICKLOCK

LEFT-HAND ENDWALL (COPING VERSION)

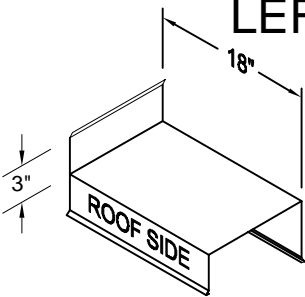

UNIQUE ID _____

FACE LEG SIZE _____

BACK LEG SIZE _____

QUANTITY _____

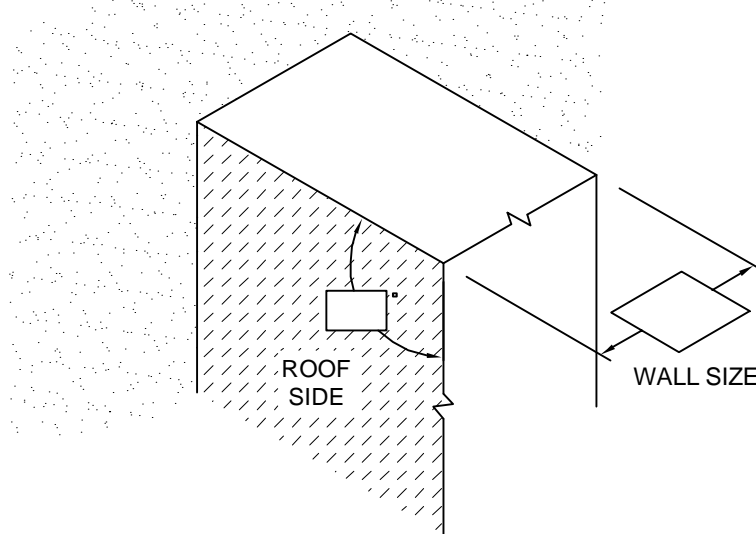

- WELDED
 QUICKLOCK

COPING:

- PERMASNAP PREMIER PLUS
- PERMASNAP PREMIER
- PERMASNAP PLUS
- PERMASNAP
- PERMASNAP CONTINUOUS CLEAT
- PERMASNAP CANTILEVER
- PERMASNAP DOUBLE SLOPE
- OTHER

MATERIALS:

METAL-LOCKED

- 24 GA GALVANIZED STEEL
- 22 GA GALVANIZED STEEL
- .040" ALUMINUM
- .050" ALUMINUM
- .063" ALUMINUM

WELDED

- .050" ALUMINUM
- .063" ALUMINUM

FINISH:

QUICKLOCK

- PRE-FINISHED KYNAR
- PRE-ANODIZED

WELDED

- 2-COAT STANDARD
- 3-COAT STANDARD
- PRE-ANODIZED
- POST-ANODIZED

COLOR: _____

CUSTOMER APPROVAL TO PROCEED

CUSTOMER OR CUSTOMER REPRESENTATIVE SHALL VERIFY ALL DIMENSIONS, COLOR(S), AND QUANTITIES. INSTALLATION SHALL BE PERFORMED IN STRICT ACCORDANCE WITH OUR INSTALLATION INSTRUCTIONS.

CUSTOMER REPRESENTATIVE: _____

COMPANY: _____

DATE/PROJECT: _____

NOTE: PLEASE REVIEW PROJECT DRAWINGS FOR CLARIFICATION OF ADDITIONAL INFORMATION. FABRICATION WILL PROCEED UPON SIGNED CUSTOMER APPROVAL.

ENDWALL FLASHING

RIGHT-HAND ENDWALL (SPLICE VERSION)

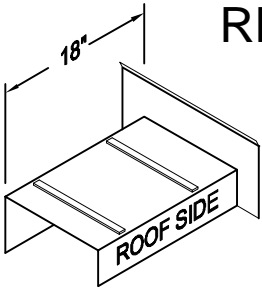

UNIQUE ID _____

FACE LEG SIZE _____

BACK LEG SIZE _____

QUANTITY _____

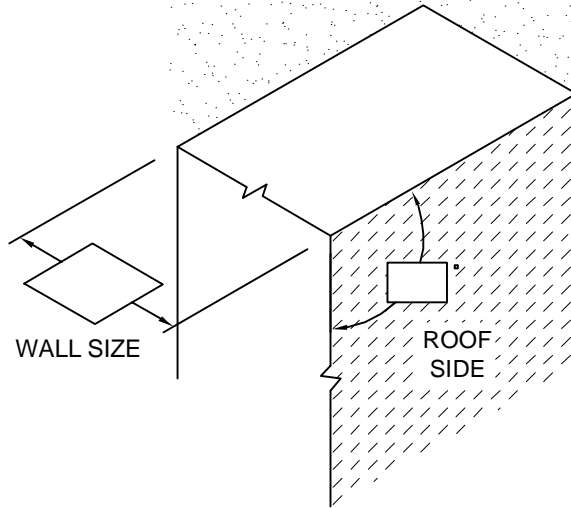

- WELDED
 QUICKLOCK

LEFT-HAND ENDWALL (SPLICE VERSION)

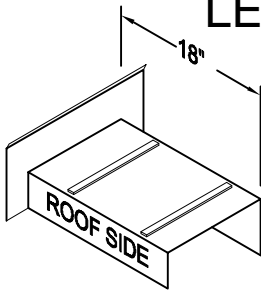

UNIQUE ID _____

FACE LEG SIZE _____

BACK LEG SIZE _____

QUANTITY _____

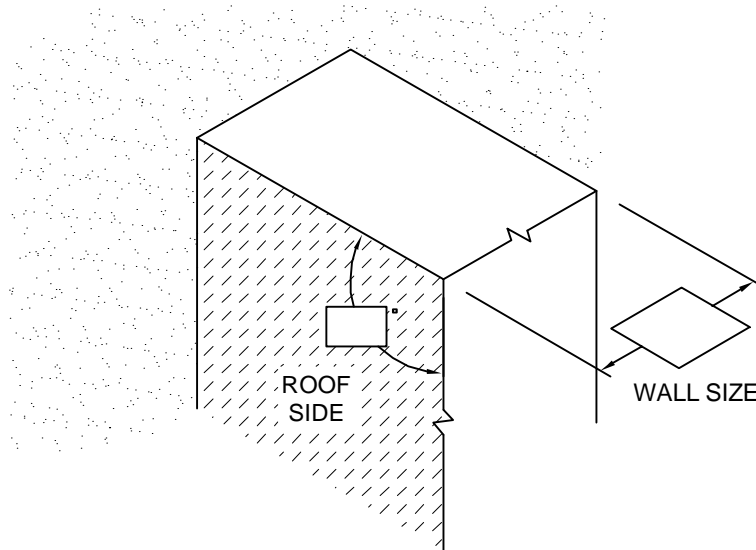

- WELDED
 QUICKLOCK

COPING:

- PERMASNAP PREMIER PLUS
- PERMASNAP PREMIER
- PERMASNAP PLUS
- PERMASNAP
- PERMASNAP CONTINUOUS CLEAT
- PERMASNAP CANTILEVER
- PERMASNAP DOUBLE SLOPE
- OTHER

MATERIALS:

METAL-LOCKED

- 24 GA GALVANIZED STEEL
- 22 GA GALVANIZED STEEL
- .040" ALUMINUM
- .050" ALUMINUM
- .063" ALUMINUM

WELDED

- .050" ALUMINUM
- .063" ALUMINUM

FINISH:

QUICKLOCK

- PRE-FINISHED KYNAR
- PRE-ANODIZED

WELDED

- 2-COAT STANDARD
- 3-COAT STANDARD
- PRE-ANODIZED
- POST-ANODIZED

COLOR: _____

CUSTOMER APPROVAL TO PROCEED

CUSTOMER OR CUSTOMER REPRESENTATIVE SHALL VERIFY ALL DIMENSIONS, COLOR(S), AND QUANTITIES.
 INSTALLATION SHALL BE PERFORMED IN STRICT ACCORDANCE WITH OUR INSTALLATION INSTRUCTIONS.

CUSTOMER REPRESENTATIVE: _____

COMPANY: _____

DATE/PROJECT: _____

NOTE: PLEASE REVIEW PROJECT DRAWINGS FOR CLARIFICATION OF ADDITIONAL INFORMATION. FABRICATION WILL PROCEED UPON SIGNED CUSTOMER APPROVAL.