



1-PIECE COUNTERFLASHING

SURFACE MOUNTED

NOTES

- No Notches Provided
- No Fasteners Provided

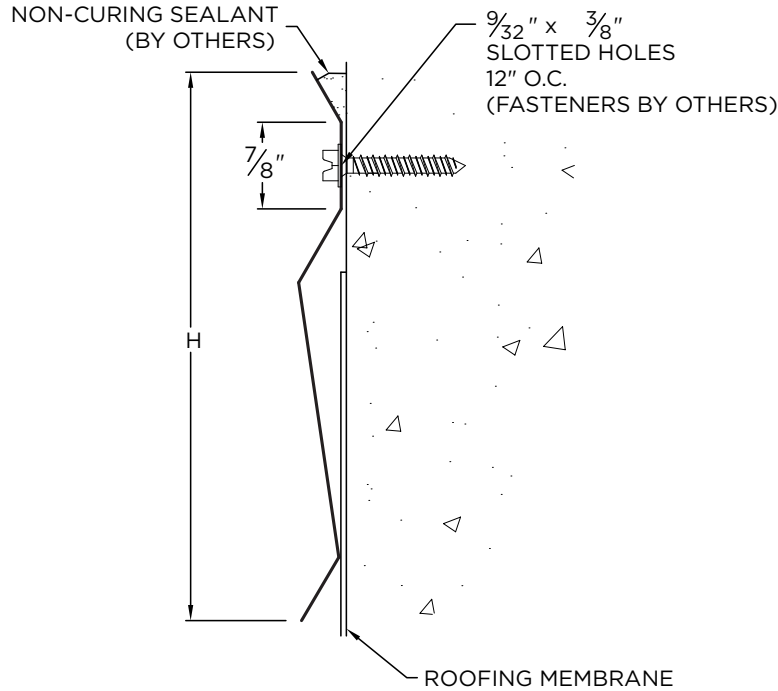

PROJECT INFO

Project Name: _____

Architect: _____

Roofing Contractor: _____

Project Type:

By selecting this box you have verified and confirmed that dimensions, sizes, and quantities are correct. All products will be installed in strict accordance with printed instructions.

Date: _____

Versico
Customer Service
800-558-2162
(Metal-Era)

SHT# 1 of 1

DATE: 02/01/ 22

DRN BY: JJC

CKD BY: MM

DWG #: 18015-15124

REV: C

DIMENSIONS

- Face Height (H)
- 3.75" (CFW-375)
- 5.625" (CFW-562)

MATERIAL

- 24 Ga. Galv. Steel
- 22 Ga. Galv. Steel
- .040" Aluminum
- .050" Aluminum
- .063" Aluminum
- OTHER: _____

Color: _____
Finish: _____

QUANTITIES

_____ Lineal Feet (12'-0" Lengths)