

ANSI/SPRI/FM4435/ES-1 TEST PRESSURES UP TO 213 PSF (HORIZONTAL)

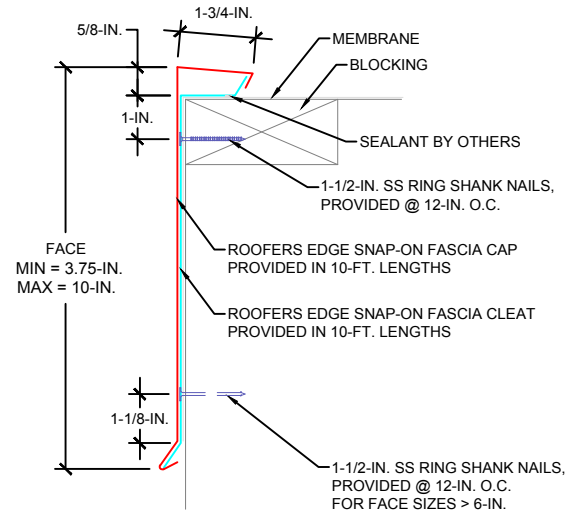

FOR MASONRY APPLICATIONS, PLEASE CONTACT OMG.
 CONTACT OMG FOR APPROPRIATE RECOMMENDATIONS NEEDED TO MEET/EXCEED
 ANSI/SPRI/FM4435/ES-1 DESIGN CRITERIA

APPLICATIONS
 SINGLE-PLY MEMBRANES
 MOD BIT
 BUR

SIZES:
 SEE DRAWING

NOTES:
 1-REFER TO ROOF MEMBRANE MANUFACTURER FOR
 THEIR APPROVED INSTALLATION DETAIL.
 2-TESTED IN ACCORDANCE WITH ANSI/SPRI/FM4435/ES-1.

ANSI/SPRI/FM4435/ES-1 TESTED

HICKMAN
 EDGE SYSTEMS

4 Commerce Way
 Arden, NC 28704
 828-675-1700
 Hickmanedgesystems.com

HICKMAN			
ROOFER'S EDGE SNAP-ON FASCIA			
DESIGN BY: PL	DATE: 03/18/2020	ISSUE	
APPROVED BY: KP	DATE: 03/18/2020	SCALE: NOT TO SCALE	SHEET: 1 OF 1